

# HD 280 PRO

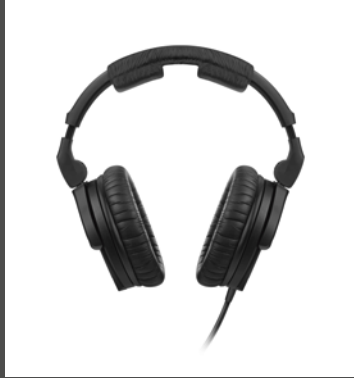

## In the box



## Adjusting

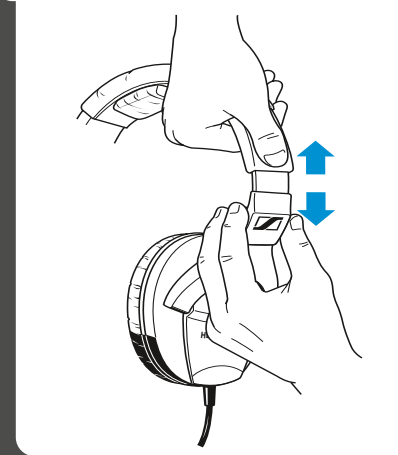

## Folding up the headphones

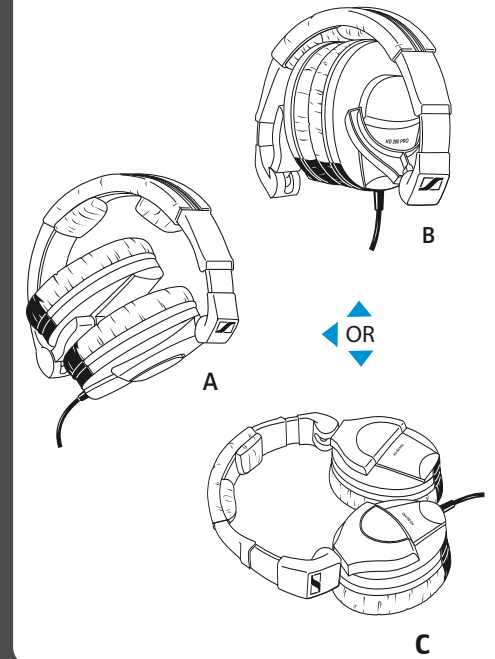

Quick Guide  
Kurzanleitung  
Guide rapide  
Guida rapida

Instrucciones resumidas  
Beknopte handleiding  
Краткая инструкция  
快速指南

## Replacing spare parts

### Headband padding

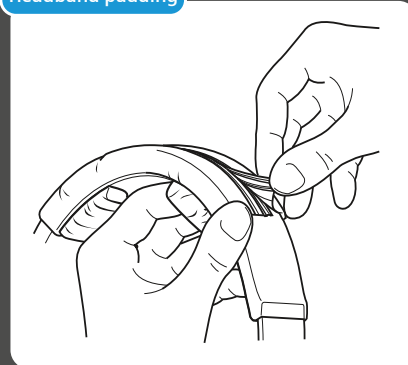

### Ear cushions

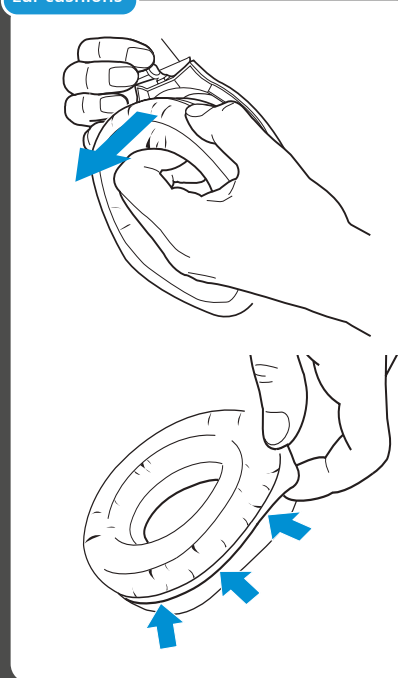

## Specifications

### Headphone HD 280 PRO

Acoustic principle	dynamic, closed
Impedance	64 Ω
Ear coupling	circumaural
Frequency response	8 - 25,000 Hz
Ambient noise attenuation	≤32 dB
THD	<0.1% (@ 1 kHz, 100 dB SPL)
Weight (w/o cable)	approx. 285 g
Contact pressure	approx. 6 N
Length of coiled cable	≥1.3 m / ≤3 m
Operating temperature	-10 °C to +55 °C
Storage temperature	-20 °C to +70 °C
Relative humidity	≤90% @ 40 °C

Sennheiser electronic GmbH & Co. KG

Am Labor 1, 30900 Wedemark, Germany  
www.sennheiser.com

04/16, 566630/A02